

The JEC Lease Boundary has displaced from the JEC starting on 12/21/2002. The site boundary was defined by the JEC on 12/21/2002. The site boundary was defined by the JEC on 12/21/2002. The site boundary was defined by the JEC on 12/21/2002.

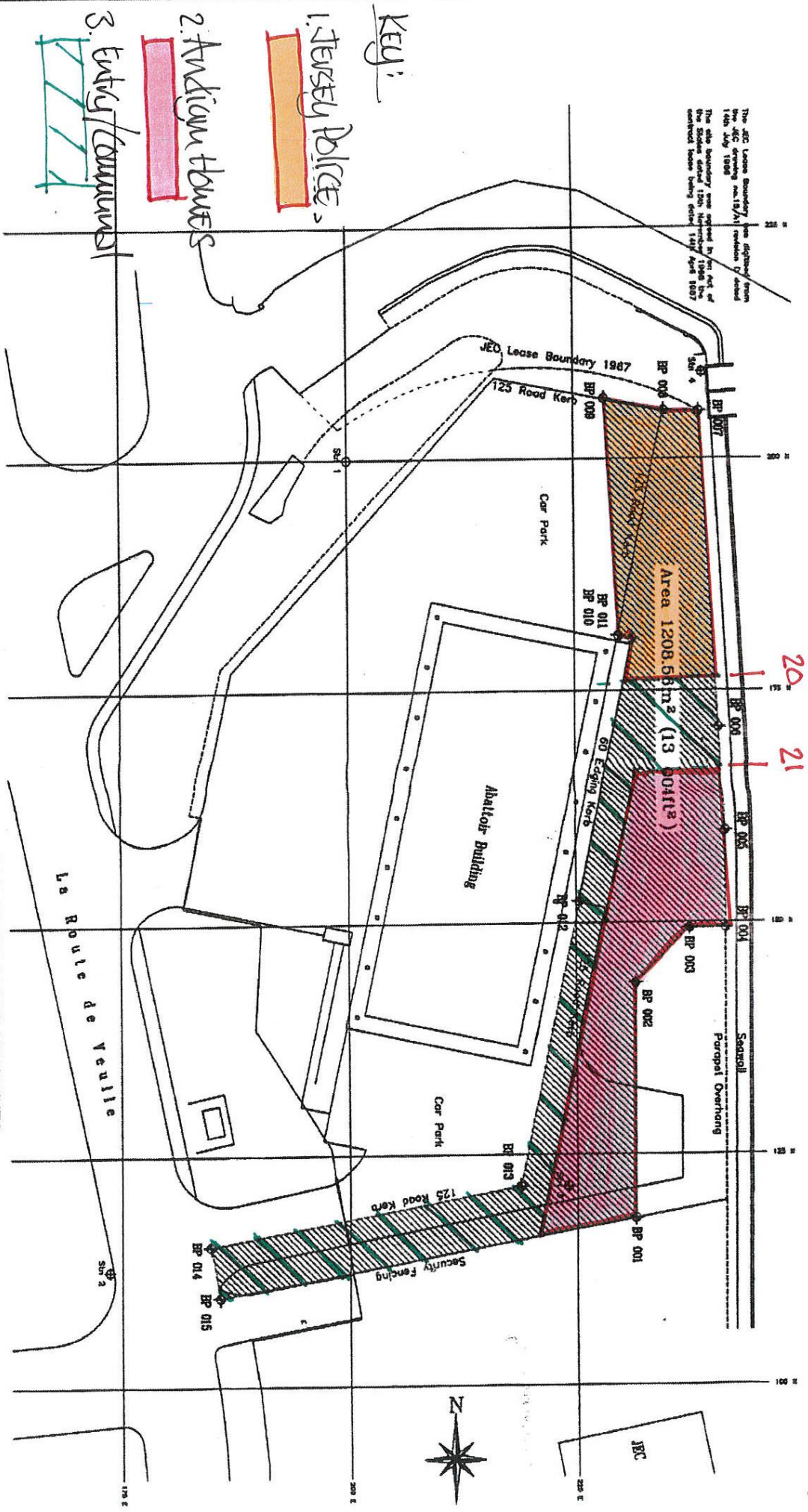

DEFINITIVE COORDINATE DEFINITION OF THE BOUNDARY POINTS
This drawing is to be read in conjunction with the coordinate listing Sheet Number PHT 565 104

PROPOSED TRANSFER OF ADMINISTRATION
OF Part of the Abattoir Site

BY The Department of Agriculture and Fisheries
TO The Harbours and Airport Committee

The Abattoir Site La Route de Veulle La Collette

Professional fit-foot Services Ltd
Consulting Land Surveyors
PO Box 705
Jersey JE1 0PP
Tel/Fax : 01 534 742482 Email : Esurvey@705.com

Surveyed : Paul & Adele Frisking
Scale : 1:400
Date : October 2002
Drawing Number : P 565 04

